

Land of David Stephens.

Christian Bowman's Land.

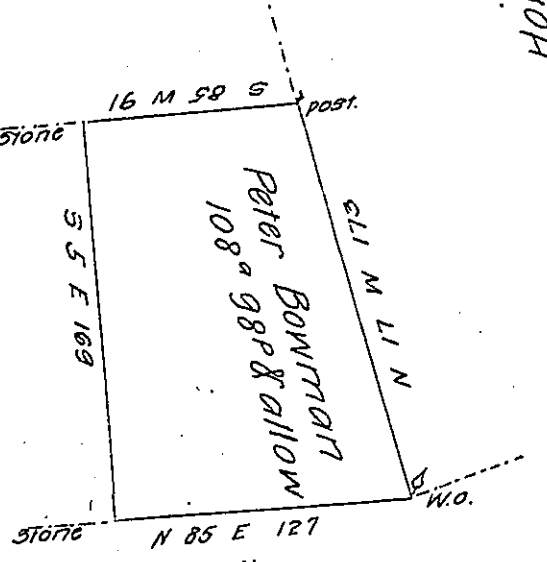

Land of George Hail

Land of Richard Peters Esq.

The draught of a tract of land Surveyed to Peter Bowman  
 (being part of 213 & 30 ps & allowance Surveyed to Christopher  
 Stiener in pursuance of a warrant dated<sup>t</sup> 24th of June 1737) Situate  
 in Robeson township in the County of Berks 6 mo. 24th 1766

Benja Lightfoot —

t Wt says 21st

IN TESTIMONY that the above is a copy of the original remaining on file in  
 the Department of Internal Affairs of Pennsylvania, made  
 conformably to an Act of Assembly approved the 16th day of  
 February, 1833, I have hereunto set my Hand and caused  
 the Seal of said Department to be affixed at Harrisburg,  
 this sixteenth day of November 1906.

*Leach B. Brown*  
 Secretary of Internal Affairs.